



William Hackett

Lifting Products Limited

HACK10

CHAIN SLING SYSTEM





Contents

Safe Just Became Safer	2
Quality Assurance and Traceability	3
Grade 10 Working Load Limits	5
Grade 10 Lifting Chain	7
Master Links	8
SubAssemblies.....	9
Component Connector	10
Eye Grab Hook	11
Clevis Clutch	12
Clevis Sling Hook	13
Eye Sling Hook	14
Clevis Self Locking Hook	15
Eye Self Locking Hook	16
Swivel Self Locking Hook	17
Reevable Link	18
Clevis Shackle	19

Safe Just Became Safer

Management Systems

William Hackett is proud to be a triple badged quality assured company. All of our business activities are conducted within quality, environmental, and occupational health and safety management systems that are certified in accordance with ISO 9001:2015, ISO 14001:2015, and ISO 45001:2018.

Holding DNV accreditation within these standards of system control, all of our products, including our Hack10 chain sling system range, undergo rigorous quality checks as part of our manufacturing process.



LEEA

William Hackett is a full member of the lifting industry trade body, Lifting Equipment Engineers Association (LEEA). Our affiliation with LEEA is strong, with our Group Business Development Director, Ben Burgess, being a member of LEEA's board. Additionally, one third of our team hold their fully qualified LEEA registered technician status, making us well equipped to improve the safety of your lifting operations.

William Hackett Assure Portal

Our Assure portal offers market leading product traceability and certification retrieval. This fully integrated stock system allows William Hackett distributors to place orders, review product purchase history, obtain current and historic test certifications, and obtain product safe use instructions, providing enhanced quality assurance to our stakeholders.

Exceeding International Standards

All of our Hack10 lifting components fully comply with the relevant requirements of the following International Standards: EN1677-4, ASTM A952/A and DIN PAS 1061. This means our Hack10 lifting components can be used in chain slings certified to EN818-4, for use in temperature ranges of -40°C up to 200°C without a reduction in Working Load Limit.

Product Support

William Hackett is fully committed to providing its customers with technical and service support through the product lifecycle, including the availability of spares and replacement components.

All statements, technical information, advice and recommendations contained within this brochure are believed to be reliable, although no guarantee is given as to their accuracy and/or completeness. The user of our products must determine the suitability of the products for their own particular purpose, either alone or in combination with other products and shall assume all risk and liability in connection with those decisions. Whilst every effort has been made to ensure accuracy in relation to the content of tables, the information contained does not form part of any contract. We reserve the right to change product information and data at any time without notice.

Quality Assurance and Traceability

Welded Components

Batch markings for Master Links & Sub Assemblies

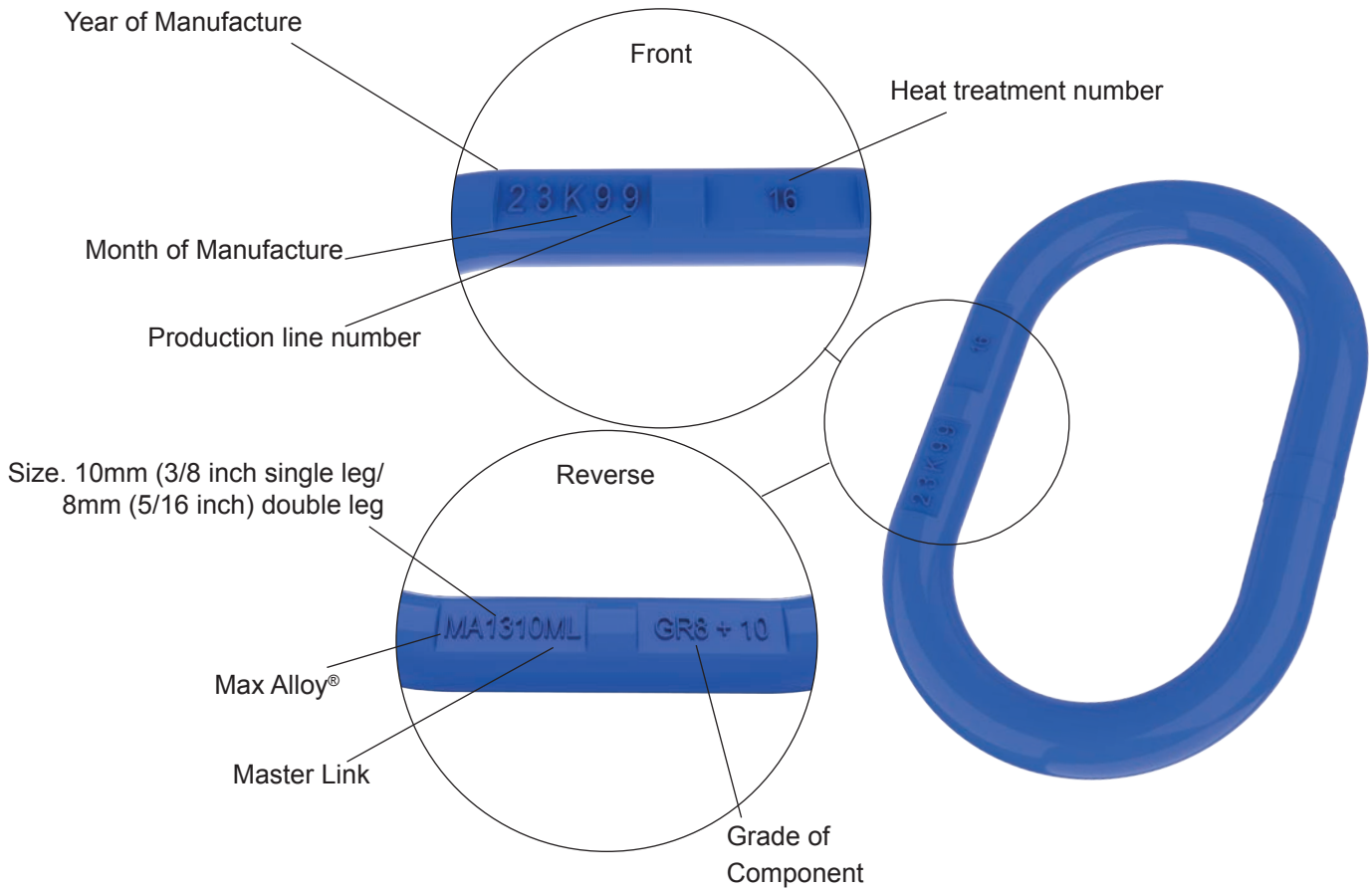

Forged Components



Quality Assurance and Traceability

Grade 10 Short Link Chain

MA10 and batch traceability marks, the mark of Max-Alloy® quality grade 10 chain, the grade that should always be used for sling or lifting appliances.

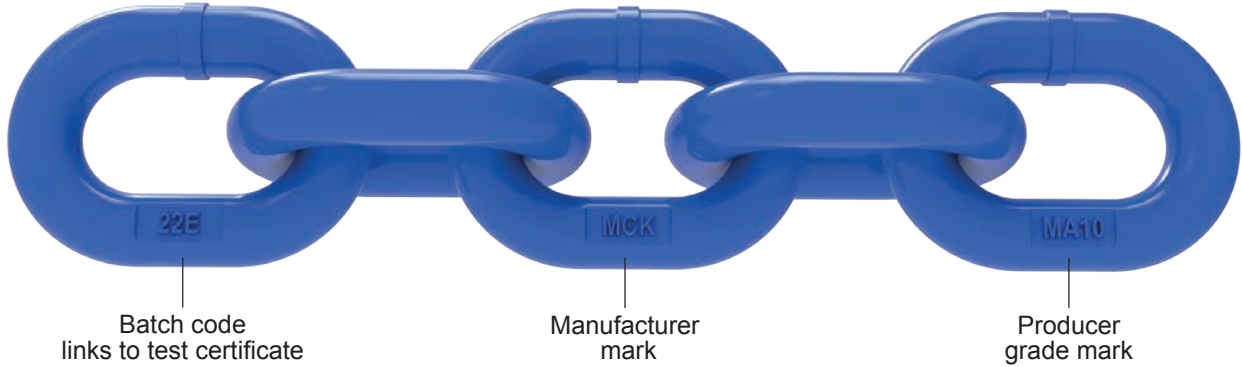

Chain Tags

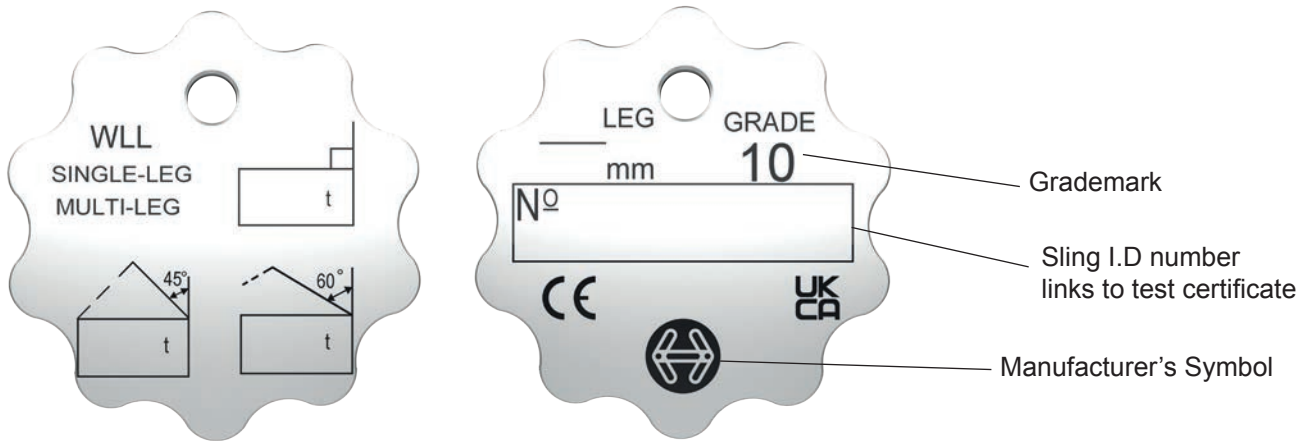

Chain Sling Assembly

- Full assembly service provided, all slings are assembled by trained and qualified staff.
- Available in the following sizes:
6mm – 32mm (Metric)
1/4 inch – 1-1/4 inch (Imperial)

William Hackett Lifting Products Limited		Full Member	DUAL PURPOSE DOCUMENT Test Certificate A Grade 100 Chain Slings are manufactured and fully comply with the requirements of ASTM906/A906M 2002 Grade 80 and Grade 100 Alloy Steel Chain Slings for Overhead Lifting					
Delivery Address WILLIAM HACKETT LIFTING PRODUCTS OAK DRIVE LIONHEART ENTERPRISE PARK ALNWICK NORTHUMBERLAND, NE66 2EU, UK	Supplied To: HAC001 Certificate Number: L126382 Customer Order No: 123456 Date Received: 22/05/2023	MANUFACTURER'S CERTIFICATE B CERTIFIED ON BEHALF OF THE COMPANY RODERICK BELL 22/05/2023						
Authorised person for the configuration of the declaration documents: Roderick Bell, William Hackett Lifting Products, Alnwick, UK								
A/B	Batch	Lot No / Serial No	Product	Description	Qty	Working Load Limit	Proof Load	Min Breaking Load
A	P37885	679822	HHX08.202.7G	5/16" 2 Leg Grade 10 Chain Sling 6ft c/w Sling hook and grab Shortener	1	12100 lbs 0-45° 8500 lbs 45-60°	11400 lbs each leg	98.1kN
B	Q62305	2822	HH10-H03-08	5/16" Hackett Grade 10 Component Connector to EN1677-1	1	2.5t	61.3kN	98.1kN
B	Q62359	2979	HH10-H05-08	5/16" Hackett Grade 10 Clevis Self Locking Hook to EN1677-1	1	2.5t	61.3kN	98.1kN
OAK DRIVE, LIONHEART ENTERPRISE PARK, ALNWICK, NORTHUMBERLAND NE66 2EU Tel. +44 (0) 1665 604200 Fax. +44 (0) 1665 604204 Email: info@williamhackett.co.uk Website: www.williamhackett.co.uk Co. Registration No. 09679580 VAT Reg. No. 217 3508 23				WH12 Issue 1 Report Version 3-0 50 20202 - 0				

Grade 10 Working Load Limits

Uniform Load Method of Rating



Chain Size		Single Leg		Endless		Two Leg				Three & Four Leg			
inch	mm	lbs	tonnes	lbs	tonnes	0-45° lbs	0-45° tonnes	45-60° lbs	45-60° tonnes	0-45° lbs	0-45° tonnes	45-60° lbs	45-60° tonnes
1/4	6	3200	1.4	5120	2.2	4500	2.0	3200	1.4	6800	2.9	4800	2.1
5/16	8	5700	2.5	9100	4.0	8100	3.5	5700	2.5	12100	5.3	8500	3.8
3/8	10	8800	4.0	14000	6.4	12400	5.6	8800	4.0	18700	8.4	13200	6.0
1/2	13	15000	6.7	23700	10.6	21200	9.5	15000	6.7	31800	14.0	22500	10.0
5/8	16	22600	10.0	36100	16.0	32000	14.0	22600	10.0	47900	21.0	33900	15.0
3/4	20	35300	16.0	56500	25.6	49900	22.4	35300	16.0	74900	33.6	53000	24.0
7/8	22	42700	19.0	68300	30.4	60400	26.5	42700	19.0	90600	40.0	64000	28.0
1	26	59600	26.5	95500	42.4	84200	37.1	59600	26.5	126400	55.7	89300	39.8
1-1/4	32	90400	40.0	146900	65.0	127800	56.0	90400	40.0	191700	85.0	135600	60.0

Grade 10 Working Load Limits

Single Leg Chain Slings

Basket Hitch (back hooked into top link)

The WLL will be the WLL for single leg slings.



Reeveable Collar Sling

The WLL will be 1.4 x the WLL for single leg slings.



Two Leg Chain Slings

Choke Hitch

The WLL will be 0.8 x the WLL for a two leg sling.

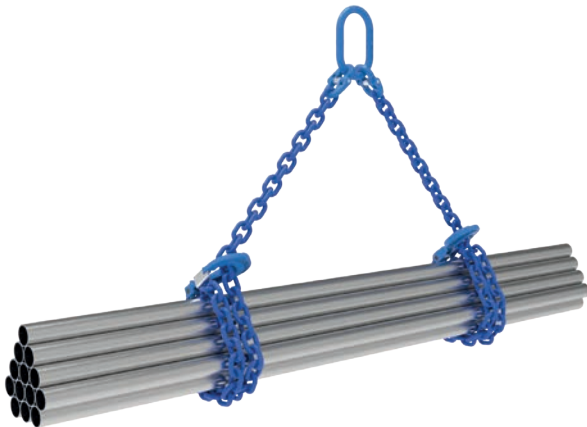

Double Basket

The WLL will be the WLL for a two leg sling.



Three & Four Leg Chain Slings

Choke Hitch

The WLL will be 0.8 x the WLL for 3 & 4 leg slings.



Straight Lift

The WLL will be the WLL for 3 & 4 leg slings.



Grade 10 Lifting Chain

Material: Grade 10 Alloy Steel

Paint Finish: Blue

Fulfills mechanical requirements in:

ASTM A973/A973M-07 (2012)

EN818+2:2008 (WLL +25%)

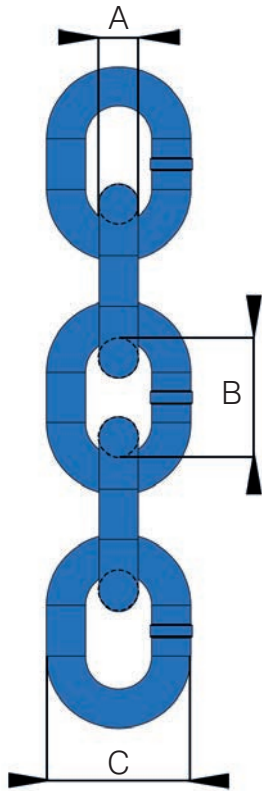

Metric Specifications

Part Code	Chain Size mm	WLL t	Kgs per metre	Metres per drum
ASV.060.5	6	1.40	0.80	500
ASV.080.5	8	2.50	1.51	350
ASV.100.5	10	4.00	2.35	250
ASV.130.5	13	6.70	3.99	150
ASV.160.5	16	10.00	5.99	100
ASV.200.5	20	16.00	9.76	60
ASV.220.5	22	19.00	11.70	50
ASV.260.5	26	26.50	16.12	30
ASV.320.5	32	40.00	24.80	25

Metric Dimensions

Part Code	Chain Size mm	A mm	B mm	C mm
ASV.060.5	6	6	18	25.9
ASV.080.5	8	8	24	29.6
ASV.100.5	10	10	30	37.0
ASV.130.5	13	13	39	48.1
ASV.160.5	16	16	48	59.2
ASV.200.5	20	20	60	74.0
ASV.220.5	22	22	66	81.4
ASV.260.5	26	26	78	96.2
ASV.320.5	32	32	96	118.0

Imperial Specifications

Part Code	Chain Size inch	WLL lbs	lbs per ft	feet per drum
ASV.060.5	1/4	3200	0.54	1640
ASV.080.5	5/16	5700	1.00	1148
ASV.100.5	3/8	8800	1.58	820
ASV.130.5	1/2	15000	2.68	492
ASV.160.5	5/8	22600	4.02	328
ASV.200.5	3/4	35300	6.56	196
ASV.220.5	7/8	42700	7.86	164
ASV.260.5	1	59800	10.83	98
ASV.320.5	1-1/4	90400	16.66	82

Imperial Dimensions

Part Code	Chain Size inch	A inch	B inch	C inch
ASV.060.5	1/4	0.24	0.70	1.02
ASV.080.5	5/16	0.31	0.94	1.16
ASV.100.5	3/8	0.39	1.18	1.45
ASV.130.5	1/2	0.51	1.54	1.90
ASV.160.5	5/8	0.63	1.89	2.33
ASV.200.5	3/4	0.78	2.36	2.91
ASV.220.5	7/8	0.86	2.59	3.20
ASV.260.5	1	1.02	3.07	3.78
ASV.320.5	1-1/4	1.26	3.78	4.65

Operating Temperature	W.L.L. Reduction
-40°C - 200°C	None
Above 200°C	Do Not Use

Master Links

Material: Alloy Steel
 Intl. Standard: ASTM 952, EN1677-4
 Paint Finish: Blue

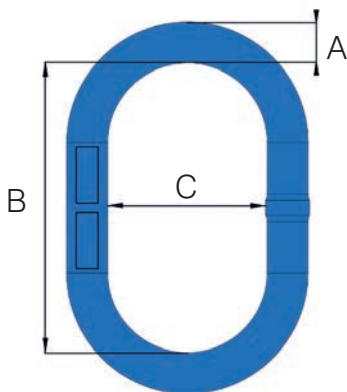

Metric Specifications

Part Code	Description	Chain Size mm Single	Chain Size mm Double	WLL t	Mass kg
10-H01-0806	MA0806ML	8	6	2.8	0.47
10-H01-1008	MA1008ML	10	8	4.2	0.72
10-H01-1310	MA1310ML	13	10	6.7	1.50
10-H01-1613	MA1613ML	16	13	11.8	3.00
10-H01-2016	MA2016ML	20	16	17.0	5.10
330.360+	HA36ML OS+	22	20	26.0	6.46
330.400+	HA40ML OS+	26	22	30.5	8.46
330.450+	HA45ML OS+	32	26	40.0	12.18
330.500+	HA65ML OS+	36	32	51.0	16.54

Oversize Master Links

330.220+	HA22ML OS+	-	10	7.00	2.28
330.250+	HA25ML OS+	16	13	9.30	3.11

Metric Dimensions

Part Code	Description	A mm	B mm	C mm
10-H01-0806	MA0806ML	14.5	125	60
10-H01-1008	MA1008ML	16.0	150	75
10-H01-1310	MA1310ML	22.0	162	90
10-H01-1613	MA1613ML	28.0	200	110
10-H01-2016	MA2016ML	32.0	270	140
330.360+	HA36ML OS+	36.0	270	140
330.400+	HA40ML OS+	40.0	280	155
330.450+	HA45ML OS+	45.0	320	175
330.500+	HA65ML OS+	50.0	350	195

Oversize Master Links

330.220+	HA22ML OS+	22.0	270	140
330.250+	HA25ML OS+	25.0	270	140

Imperial Specifications

Part Code	Description	Chain Size inch Single	Chain Size inch Double	WLL lbs	Mass lbs
10-H01-0806	MA0806ML	5/16	1/4	5700	1.04
10-H01-1008	MA1008ML	3/8	5/16	8800	1.59
10-H01-1310	MA1310ML	1/2	3/8	15000	3.30
10-H01-1613	MA1613ML	5/8	1/2	22600	6.60
10-H01-2016	MA2016ML	3/4	5/8	35300	11.24
330.360+	HA36ML OS+	7/8	3/4	49900	14.24
330.400+	HA40ML OS+	1	7/8	60400	18.65
330.450+	HA45ML OS+	1-1/4	1	84200	26.85
330.500+	HA65ML OS+	1-3/8	1-1/4	127800	36.46

Oversize Master Links

330.220+	HA22ML OS+	-	3/8	15432	5.02
330.250+	HA25ML OS+	5/8	1/2	20502	6.85

Imperial Dimensions

Part Code	Description	A inch	B inch	C inch
10-H01-0806	MA0806ML	0.57	4.92	2.36
10-H01-1008	MA1008ML	0.63	5.90	2.95
10-H01-1310	MA1310ML	0.86	6.37	3.54
10-H01-1613	MA1613ML	1.10	7.87	4.33
10-H01-2016	MA2016ML	1.26	10.63	5.51
330.360+	HA36ML OS+	1.41	10.63	5.51
330.400+	HA40ML OS+	1.57	11.00	6.10
330.450+	HA45ML OS+	1.77	12.60	6.89
330.500+	HA65ML OS+	1.97	13.78	7.67

Oversize Master Links

330.220+	HA22ML OS+	0.88	10.63	5.51
330.250+	HA25ML OS+	0.98	10.63	5.51

Sub Assemblies

Material: Alloy Steel
 Intl. Standard: ASTM 952, EN1677-4
 Paint Finish: Blue

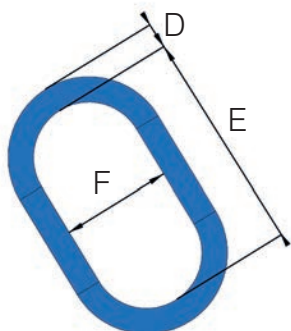
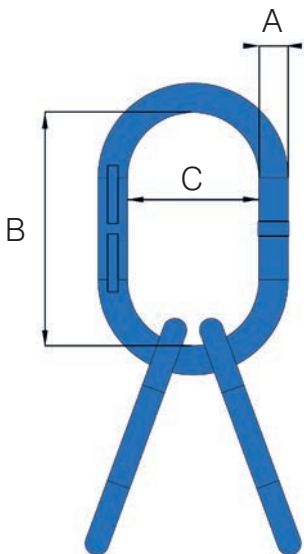

Metric Specifications

Part Code	Description	Chain Size mm	WLL t	Mass kg
10-H02-06	MA06SA	6	4.2	1.62
10-H02-08	MA08SA	8	5.3	2.84
10-H02-10	MA10SA	10	8.4	5.89
10-H02-13	MA13SA	13	14.0	7.96
10-H02-16	MA16SA	16	21.0	12.40
350.450+	HA45QA OS+	20	30.5	18.50
350.500+	HA50QA OS+	22	40.0	25.09
350.650+	HA65QA OS+	26	51.0	40.89
350.750+	HA75QA OS+	32	75.0	66.10

Oversize Sub Assemblies

350.250+	HA25QA OS+	10	9.30	6.05
----------	------------	----	------	------

Metric Dimensions

Part Code	Description	Chain Size mm	A mm	B mm	C mm	D mm	E mm	F mm
10-H02-06	MA06SA	6	16	150	75	14.5	125	60
10-H02-08	MA08SA	8	22	162	90	16.0	150	75
10-H02-10	MA10SA	10	28	200	110	22.0	162	90
10-H02-13	MA13SA	13	32	270	140	22.0	162	90
10-H02-16	MA16SA	16	36	270	140	28.0	200	110
350.450+	HA45QA OS+	20	40	280	155	32.0	270	140
350.500+	HA50QA OS+	22	45	320	175	36.0	270	140
350.650+	HA65QA OS+	26	50	350	195	45.0	320	175
350.750+	HA75QA OS+	32	65	410	220	50.0	350	195

Oversize Sub Assemblies

350.250+	HA25QA OS+	10	25	270	140	20	140	70
----------	------------	----	----	-----	-----	----	-----	----

Imperial Specifications

Part Code	Description	Chain Size inch	WLL lbs	Mass lbs
10-H02-06	MA06SA	1/4	6800	3.57
10-H02-08	MA08SA	5/16	12100	6.26
10-H02-10	MA10SA	3/8	18700	12.99
10-H02-13	MA13SA	1/2	31800	17.55
10-H02-16	MA16SA	5/8	47900	27.34
350.450+	HA45QA OS+	3/4	74900	40.78
350.500+	HA50QA OS+	7/8	90600	55.31
350.650+	HA65QA OS+	1	126400	90.14
350.750+	HA75QA OS+	1-1/4	191700	145.73

Oversize Sub Assemblies

350.250+	HA25QA OS+	3/8	20502	13.33
----------	------------	-----	-------	-------

Imperial Dimensions

Part Code	Description	Chain Size inch	A inch	B inch	C inch	D inch	E inch	F inch
10-H02-06	MA06SA	1/4	0.63	5.90	2.95	0.57	4.92	2.36
10-H02-08	MA08SA	5/16	0.86	6.37	3.54	0.63	5.90	2.95
10-H02-10	MA10SA	3/8	1.10	7.87	4.33	0.86	6.37	3.54
10-H02-13	MA13SA	1/2	1.26	10.63	5.51	0.86	6.37	3.54
10-H02-16	MA16SA	5/8	1.41	10.63	5.51	1.10	7.87	4.33
350.450+	HA45QA OS+	3/4	1.57	11.00	6.10	1.26	10.63	5.51
350.500+	HA50QA OS+	7/8	1.77	12.60	6.89	1.41	10.63	5.51
350.650+	HA65QA OS+	1	1.97	13.78	7.67	1.77	12.60	6.89
350.750+	HA75QA OS+	1-1/4	2.56	16.14	8.66	1.97	13.78	7.67

Oversize Sub Assemblies

350.250+	HA25QA OS+	3/8	0.98	10.63	5.51	0.79	5.51	2.76
----------	------------	-----	------	-------	------	------	------	------

Component Connector

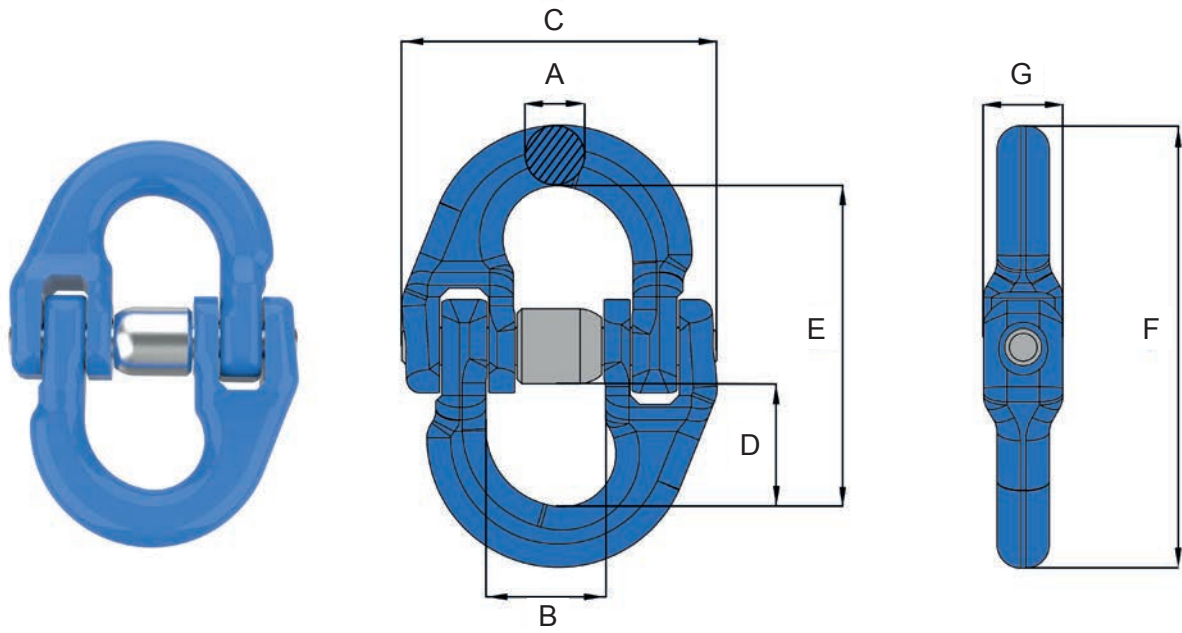

Metric Specifications

Part Code	Chain Size mm	A mm	B mm	C mm	D mm	E mm	F mm	G mm	WLL tonnes	Box Qty.	Mass Kg
10-H03-06	6	7.0	14.0	40.0	16.0	44.5	62.0	12.0	1.4	200	0.11
10-H03-08	8	10.0	18.5	53.0	24.0	63.0	84.0	14.0	2.5	150	0.18
10-H03-10	10	12.6	23.0	64.0	28.0	71.0	97.0	18.0	4.0	50	0.34
10-H03-13	13	16.5	28.0	81.0	34.0	92.5	126.0	23.0	6.7	35	0.68
10-H03-16	16	20.0	33.5	103.0	39.0	106.5	145.0	30.0	10.0	20	1.22
10-H03-20	20	25.0	42.0	119.5	44.0	123.0	175.0	35.0	16.0	10	2.13
10-H03-22	22	27.0	48.0	142.0	50.0	137.5	193.0	39.0	19.0	6	3.00
10-H03-26	26	32.0	61.0	169.0	63.0	161.0	229.0	46.0	26.5	3	5.20
10-H03-32	32	40.0	80.0	218.0	78.0	197.0	279.0	54.0	40.0	2	9.55

Imperial Specifications

Part Code	Chain Size inch	A inch	B inch	C inch	D inch	E inch	F inch	G inch	WLL lbs	Box Qty.	Mass lbs
10-H03-06	1/4	0.27	0.55	1.57	0.63	1.75	2.44	0.47	3200	200	0.24
10-H03-08	5/16	0.39	0.73	2.08	0.94	2.48	3.31	0.55	5700	150	0.39
10-H03-10	3/8	0.49	0.90	2.52	1.10	2.80	3.82	0.71	8800	50	0.74
10-H03-13	1/2	0.65	1.10	3.19	1.34	3.64	4.96	0.91	15000	35	1.49
10-H03-16	5/8	0.78	1.32	4.05	1.54	4.19	5.71	1.18	22600	20	2.68
10-H03-20	3/4	0.98	1.65	4.70	1.73	4.84	6.89	1.38	35300	10	4.69
10-H03-22	7/8	1.06	1.89	5.59	1.97	5.41	7.60	1.54	42700	6	6.61
10-H03-26	1	1.26	2.40	6.65	2.48	6.34	9.01	1.81	59800	3	11.46
10-H03-32	1-1/4	1.57	3.15	8.58	3.07	7.76	10.98	2.13	90400	2	21.05

Eye Grab Hook

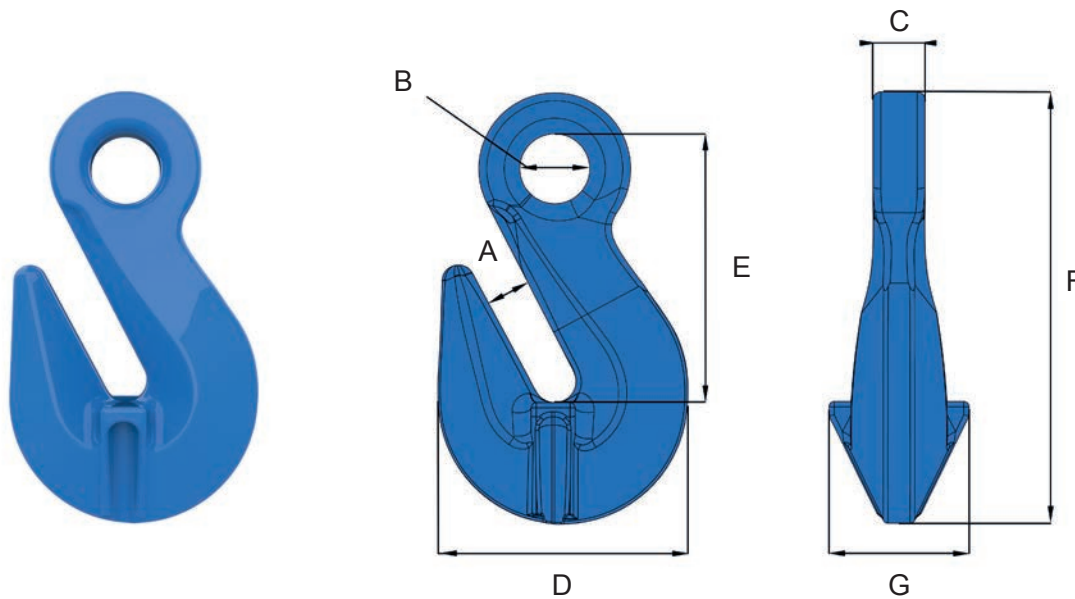

Metric Specifications

Part Code	Chain Size mm	A mm	B mm	C mm	D mm	E mm	F mm	G mm	WLL tonnes	Box Qty.	Mass Kg
10-H06-06	6	8.0	13.5	8.0	46.5	46.0	73.0	25.5	1.4	100	0.15
10-H06-08	8	11.0	17.5	9.5	53.0	61.0	93.0	33.5	2.5	80	0.30
10-H06-10	10	13.5	22.0	14.0	74.0	85.0	129.0	42.0	4.0	40	0.79
10-H06-13	13	17.0	27.0	18.5	96.0	104.0	166.0	53.5	6.7	12	1.67
10-H06-16	16	19.0	36.0	22.0	116.0	119.0	186.0	74.0	10.0	10	2.74
10-H06-20	20	25.0	44.0	23.0	145.0	146.0	225.0	87.0	16.0	6	4.72
10-H06-22	22	27.0	48.5	26.0	160.5	165.5	260.5	90.0	19.0	5	8.20
10-H06-26	26	34.0	52.0	34.0	190.0	204.0	311.0	110.0	26.5	2	11.35
10-H06-32	32	41.0	64.0	40.0	229.0	246.0	373.0	130.0	40.0	1	20.65

Imperial Specifications

Part Code	Chain Size inch	A inch	B inch	C inch	D inch	E inch	F inch	G inch	WLL lbs	Box Qty.	Mass lbs
10-H06-06	1/4	0.31	0.53	0.31	1.83	1.81	2.87	1.00	3200	100	0.33
10-H06-08	5/16	0.43	0.69	0.37	2.08	2.40	3.66	1.32	5700	80	0.66
10-H06-10	3/8	0.53	0.86	0.55	2.91	3.35	5.08	1.65	8800	40	1.74
10-H06-13	1/2	0.67	1.06	0.73	3.78	4.09	6.53	2.10	15000	12	3.68
10-H06-16	5/8	0.75	1.42	0.87	4.57	4.68	7.32	2.91	22600	10	6.04
10-H06-20	3/4	0.98	1.73	0.90	5.70	5.75	8.86	3.42	35300	6	10.40
10-H06-22	7/8	1.06	1.91	1.02	6.32	6.51	10.25	3.54	42700	5	18.07
10-H06-26	1	1.34	2.05	1.34	7.48	8.03	12.24	4.33	59800	2	25.02
10-H06-32	1-1/4	1.61	2.52	1.57	9.01	9.68	14.68	5.12	90400	1	45.52

Clevis Clutch

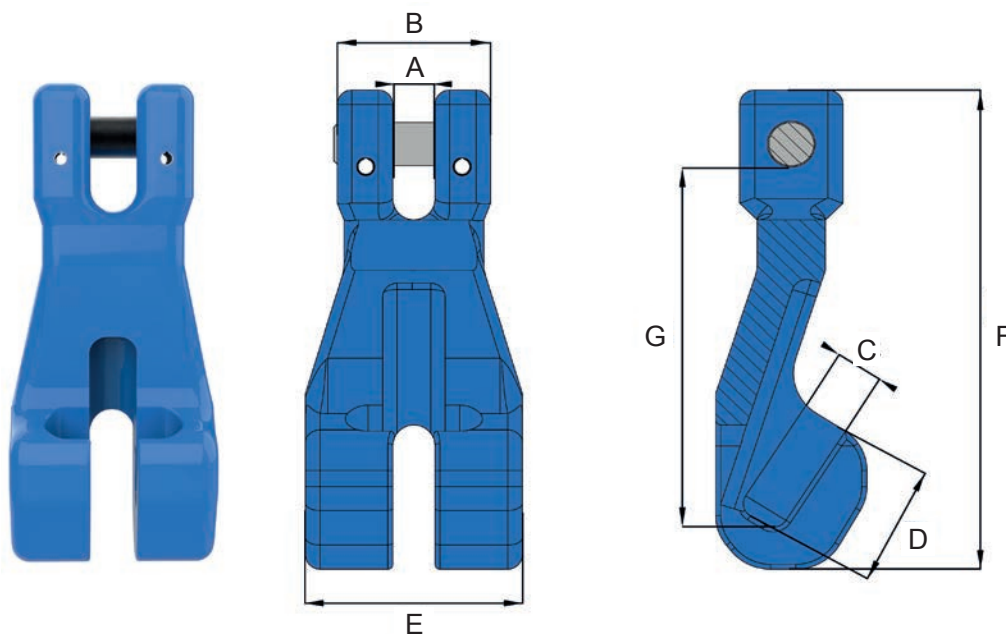

Metric Specifications

Part Code	Chain Size mm	A mm	B mm	C mm	D mm	E mm	F mm	G mm	WLL tonnes	Box Qty.	Mass Kg
10-H10-08	8	9.5	36.0	10.5	17.0	45.0	101.0	70.0	2.5	50	0.37
10-H10-10	10	13.0	48.0	12.4	28.0	55.0	138.0	101.5	4.0	21	0.97
10-H10-13	13	16.5	59.0	16.0	34.5	75.0	177.0	115.0	6.7	10	2.01
10-H10-16	16	18.5	70.0	19.5	40.0	93.0	220.0	150.5	10.0	6	3.32

Imperial Specifications

Part Code	Chain Size inch	A inch	B inch	C inch	D inch	E inch	F inch	G inch	WLL lbs	Box Qty.	Mass lbs
10-H10-08	5/16	0.37	1.42	0.41	0.67	1.77	3.97	2.75	5700	50	0.81
10-H10-10	3/8	0.51	1.89	0.49	1.10	2.17	5.43	3.99	8800	21	2.13
10-H10-13	1/2	0.65	2.32	0.63	1.36	2.95	6.97	4.53	15000	10	4.43
10-H10-16	5/8	0.73	2.75	0.77	1.57	3.66	8.66	5.93	22600	6	7.31

Clevis Sling Hook

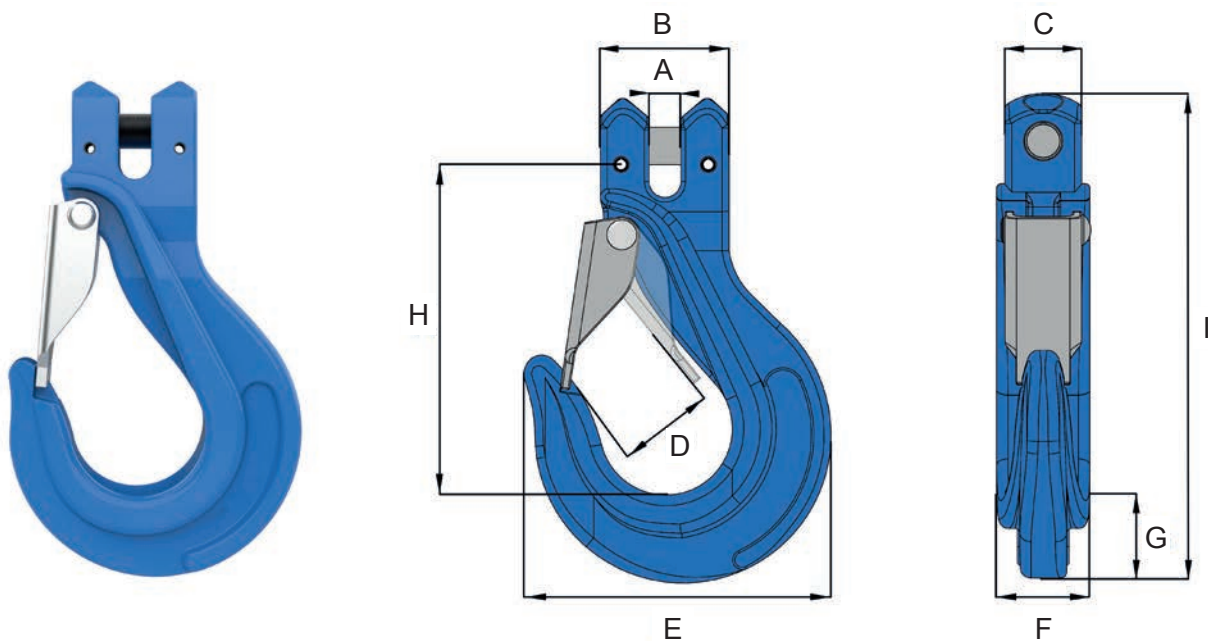

Metric Specifications

Part Code	Chain Size mm	A mm	B mm	C mm	D mm	E mm	F mm	G mm	H mm	I mm	WLL tonnes	Box Qty.	Mass Kg
10-H04-06	6	8.0	28.5	18.0	23.0	66.0	15.5	19.0	79.0	112.0	1.4	40	0.30
10-H04-08	8	9.0	35.0	23.0	27.0	85.0	20.0	25.0	99.3	140.0	2.5	30	0.59
10-H04-10	10	12.0	44.0	25.5	33.0	103.0	24.0	28.0	121.0	174.0	4	15	1.19
10-H04-13	13	15.0	57.0	34.0	40.0	133.0	38.0	38.0	147.6	213.6	6.7	8	2.32
10-H04-16	16	18.5	67.0	41.5	44.0	161.0	41.5	41.0	166.0	245.0	10	6	3.95
10-H04-20	20	23.0	80.0	51.0	53.0	187.0	48.0	50.0	200.0	292.0	16	3	6.77
10-H04-22	22	25.0	97.5	61.0	72.0	240.0	57.0	63.0	228.0	339.0	19	2	10.0

Imperial Specifications

Part Code	Chain Size inch	A inch	B inch	C inch	D inch	E inch	F inch	G inch	H inch	I inch	WLL lbs	Box Qty.	Mass lbs
10-H04-06	1/4	0.31	1.12	0.71	0.91	2.60	0.61	0.75	3.11	4.41	3200	40	0.66
10-H04-08	5/16	0.35	1.38	0.90	1.06	3.35	0.78	0.98	3.91	5.51	5700	30	1.30
10-H04-10	3/8	0.47	1.73	1.00	1.30	4.05	0.94	1.10	4.76	6.85	8800	15	2.62
10-H04-13	1/2	0.59	2.24	1.34	1.57	5.24	1.49	1.49	5.81	8.41	15000	8	5.11
10-H04-16	5/8	0.73	2.64	1.63	1.73	6.34	1.63	1.61	6.53	9.65	22600	6	8.71
10-H04-20	3/4	0.90	3.15	2.00	2.09	7.36	1.89	1.97	7.87	11.50	35300	3	14.92
10-H04-22	7/8	0.98	3.84	2.40	2.83	9.45	2.24	2.48	8.97	13.35	42700	2	22.04

Eye Sling Hook

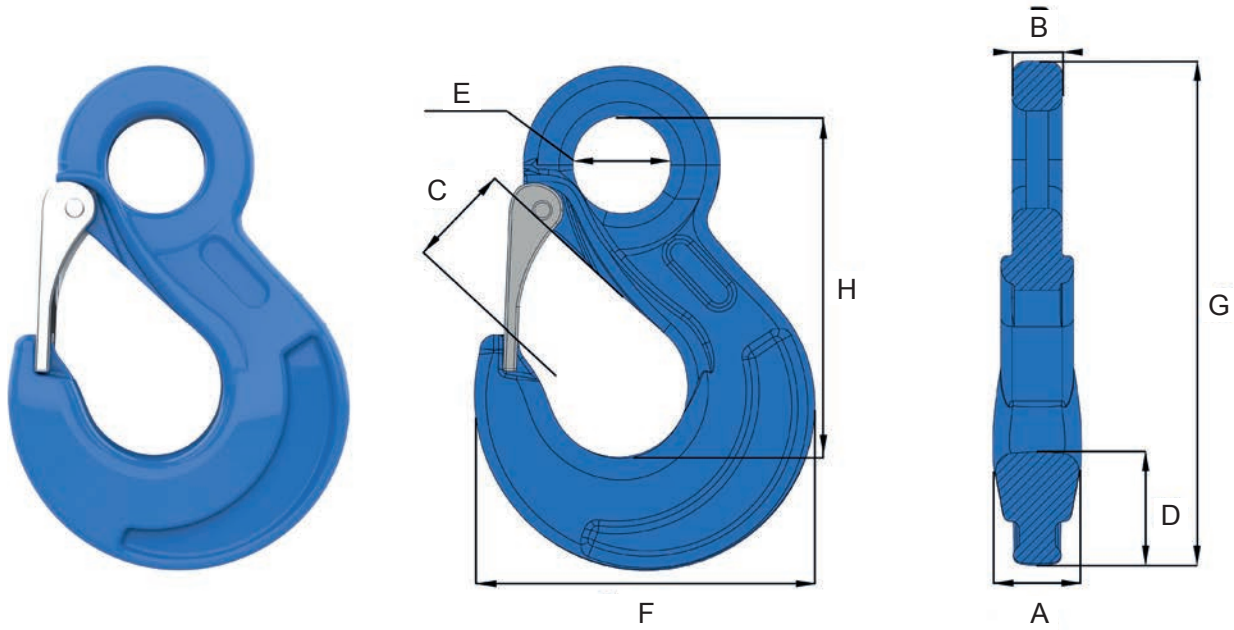

Metric Specifications

Part Code	Chain Size mm	A mm	B mm	C mm	D mm	E mm	F mm	G mm	H mm	WLL tonnes	Box Qty.	Mass Kg
10-H15-08	8	17.0	11.0	25.0	27.5	25.0	87.0	137.0	99.0	2.5	25	0.60
10-H15-10	10	24.0	16.0	29.5	33.0	32.0	105.0	170.0	120.0	4.0	15	1.20
10-H15-13	13	33.0	19.0	38.0	43.5	43.0	138.0	219.0	156.5	6.7	9	2.20
10-H15-16	16	40.0	24.5	46.0	50.0	51.0	158.0	260.0	185.5	10.0	6	3.50
10-H15-20	20	48.0	27.0	50.0	56.0	55.0	190.0	298.0	215.0	16.0	2	6.20
10-H15-22	22	50.0	29.0	64.0	62.0	60.0	214.0	330.0	239.0	19.0	2	8.50
10-H15-26	26	60.0	35.0	70.0	75.0	70.0	245.0	376.0	265.0	26.5	2	12.20
10-H15-32	32	71.0	39.0	82.0	89.0	81.5	270.0	458.0	331.0	40.0	2	17.50

Imperial Specifications

Part Code	Chain Size inch	A inch	B inch	C inch	D inch	E inch	F inch	G inch	H inch	WLL lbs	Box Qty.	Mass lbs
10-H15-08	5/16	0.67	0.43	0.98	1.08	0.98	3.43	5.39	3.90	5700	25	1.32
10-H15-10	3/8	0.94	0.63	1.16	1.30	1.26	4.13	6.69	4.72	8800	15	2.65
10-H15-13	1/2	1.30	0.75	1.50	1.71	1.69	5.43	8.62	6.16	15000	9	4.85
10-H15-16	5/8	1.57	0.96	1.81	1.97	2.01	6.22	10.24	7.30	22600	6	7.72
10-H15-20	3/4	1.89	1.06	1.97	2.20	2.17	7.48	11.73	8.46	35300	2	13.67
10-H15-22	7/8	1.97	1.14	2.52	2.44	2.36	8.43	12.99	9.41	42700	2	18.74
10-H15-26	1	2.36	1.38	2.76	2.95	2.75	9.64	14.80	10.43	59800	2	26.89
10-H15-32	1-1/4	2.80	1.53	3.23	3.50	3.21	10.63	18.03	13.03	90400	2	38.58

Clevis Self Locking Hook

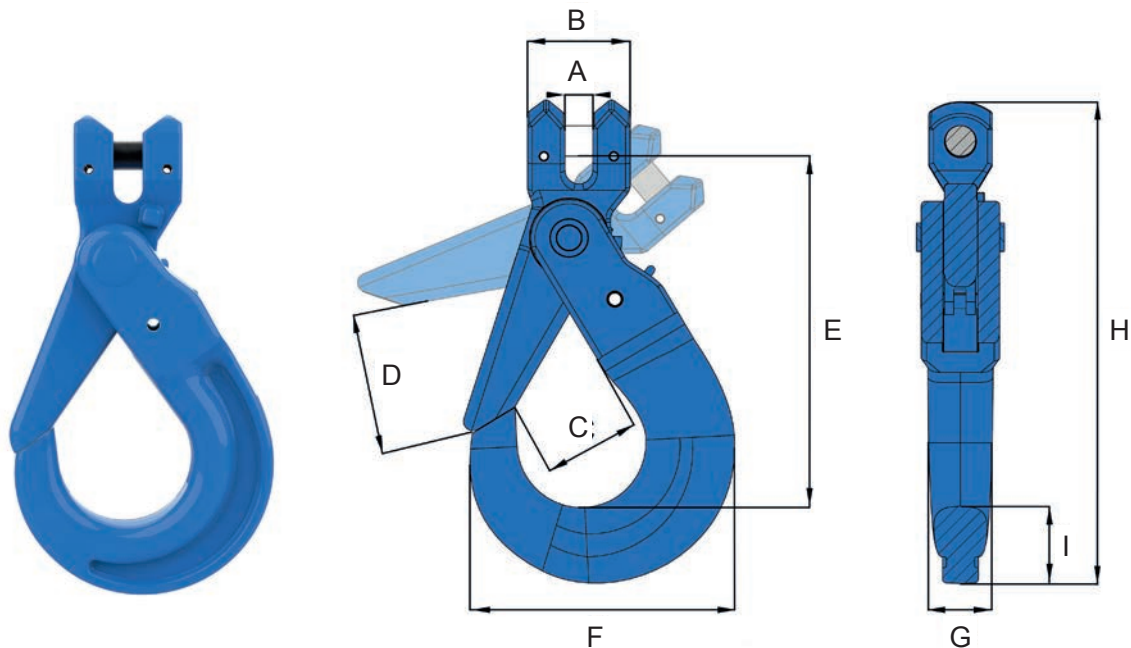

Metric Specifications

Part Code	Chain Size mm	A mm	B mm	C mm	D mm	E mm	F mm	G mm	H mm	I mm	WLL tonnes	Box Qty.	Mass Kg
10-H05-06	6	8.0	32.0	28.0	31.5	96.0	73.0	15.0	131.0	21.0	1.4	40	0.5
10-H05-08	8	9.5	36.0	36.0	40.0	121.0	90.0	20.0	163.0	27.0	2.5	20	0.9
10-H05-10	10	12.0	46.0	45.0	46.0	144.0	108.0	26.0	194.0	30.0	4.0	15	1.6
10-H05-13	13	15.0	59.0	53.6	66.0	182.0	137.0	32.5	251.0	41.0	6.7	6	2.9
10-H05-16	16	18.5	70.0	61.0	75.0	220.0	168.0	38.0	303.0	51.0	10.0	4	5.0
10-H05-20	20	25.0	85.0	76.5	80.0	235.0	190.0	50.0	337.0	64.0	16.0	2	8.6
10-H05-22	22	25.5	98.0	76.0	104.6	271.0	202.0	52.0	386.0	67.0	19.0	2	12.1

Imperial Specifications

Part Code	Chain Size inch	A inch	B inch	C inch	D inch	E inch	F inch	G inch	H inch	I inch	WLL lbs	Box Qty.	Mass lbs
10-H05-06	1/4	0.31	1.26	1.10	1.24	3.78	2.87	0.59	5.16	0.83	3200	40	1.10
10-H05-08	5/16	0.37	1.42	1.42	1.57	4.76	3.54	0.79	6.42	1.06	5700	20	1.98
10-H05-10	3/8	0.47	1.81	1.77	1.81	5.67	4.25	1.02	7.64	1.18	8800	15	3.52
10-H05-13	1/2	0.59	2.32	2.11	2.60	7.16	5.39	1.28	9.88	1.61	15000	6	6.39
10-H05-16	5/8	0.73	2.75	2.40	2.95	8.66	6.61	1.50	11.93	2.01	22600	4	11.02
10-H05-20	3/4	0.98	3.35	3.01	3.15	9.25	7.48	1.97	13.27	2.52	35300	2	18.95
10-H05-22	7/8	1.00	3.86	2.99	4.12	10.67	7.95	2.05	15.19	2.64	42700	2	26.67

Eye Self Locking Hook

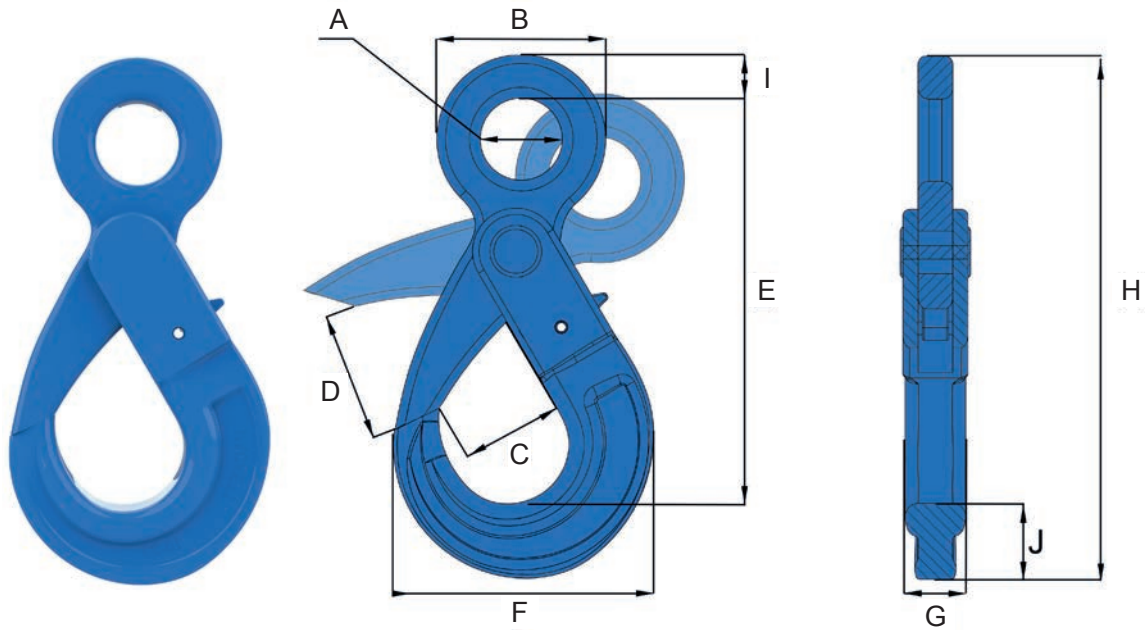

Metric Specifications

Part Code	Chain Size mm	A mm	B mm	C mm	D mm	E mm	F mm	G mm	H mm	I mm	J mm	WLL tonnes	Box Qty.	Mass Kg
10-H13-08	8	27.0	51.0	36.0	40.0	137.0	90.0	20.0	175.0	12.0	26.0	2.5	12	0.90
10-H13-10	10	34.5	64.5	45.0	46.0	170.0	108.0	26.0	212.0	15.0	27.0	4.0	8	1.50
10-H13-13	13	40.0	80.0	53.6	66.0	209.0	137.5	32.5	269.0	20.0	40.0	6.7	6	2.70
10-H13-16	16	50.0	104.0	61.0	75.0	256.0	170.5	38.0	333.0	27.0	50.0	10.0	3	5.70
10-H13-20	20	60.0	124.0	76.5	80.0	277.0	191.5	50.0	368.5	30.0	62.0	16.0	2	7.90
10-H13-22	22	70.0	139.0	76.0	100.0	319.0	205.0	52.0	417.0	33.0	65.0	19.0	2	11.20
10-H13-26	26	76.0	154.0	99.0	107.0	370.0	251.0	60.0	489.0	38.0	81.0	26.5	1	20.50
10-H13-32	32	95.0	195.0	138.0	142.0	469.0	329.0	75.0	620.0	50.0	101.0	40.0	1	40.35

Imperial Specifications

Part Code	Chain Size inch	A inch	B inch	C inch	D inch	E inch	F inch	G inch	H inch	I inch	J inch	WLL lbs	Box Qty.	Mass lbs
10-H13-08	5/16	1.06	2.01	1.42	1.57	5.39	3.54	0.79	6.89	0.47	1.02	5700	12	1.98
10-H13-10	3/8	1.36	2.54	1.77	1.81	6.69	4.25	1.02	8.35	0.59	1.06	8800	8	3.31
10-H13-13	1/2	1.57	3.15	2.11	2.60	8.23	5.41	1.28	10.59	0.79	1.57	15000	6	5.95
10-H13-16	5/8	1.97	4.09	2.40	2.95	10.08	6.71	1.50	13.11	1.06	1.97	22600	3	12.57
10-H13-20	3/4	2.36	4.88	3.01	3.15	10.91	7.54	1.97	14.51	1.18	2.44	35300	2	17.42
10-H13-22	7/8	2.76	5.47	2.99	3.94	12.56	8.07	2.05	16.42	1.30	2.56	42700	2	24.69
10-H13-26	1	2.99	6.06	3.90	4.21	14.56	9.88	2.36	19.25	1.50	3.19	59800	1	45.19
10-H13-32	1-1/4	3.74	7.68	5.43	5.59	18.46	12.95	2.95	24.40	1.97	3.97	90400	1	88.95

Swivel Self Locking Hook

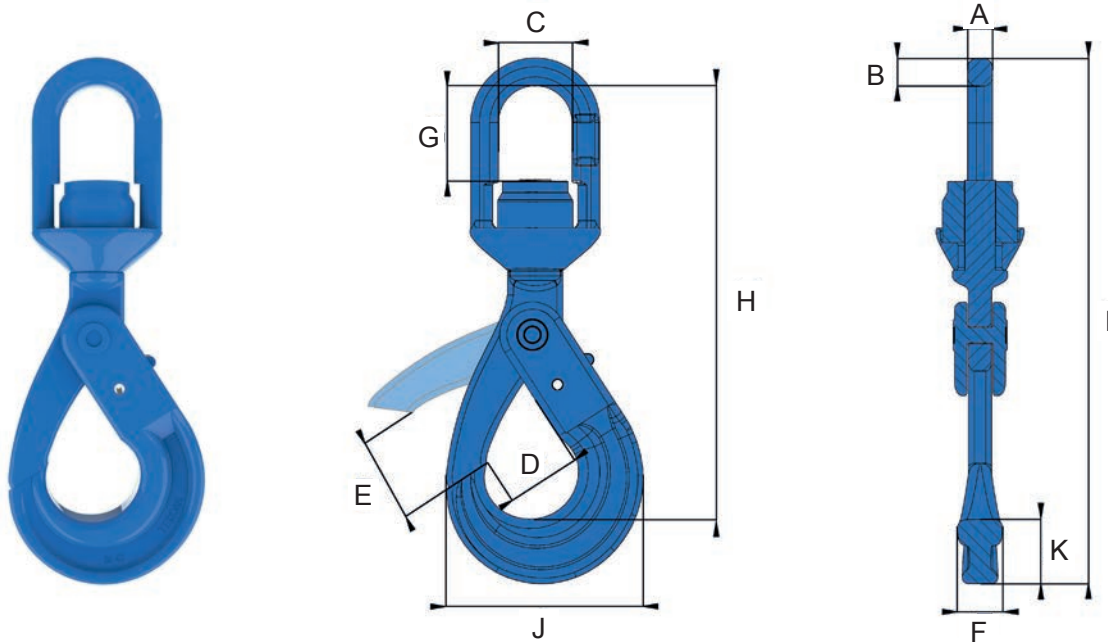

Metric Specifications

Part Code	Chain Size mm	A mm	B mm	C mm	D mm	E mm	F mm	G mm	H mm	I mm	J mm	K mm	WLL tonnes	Box Qty.	Mass Kg
10-H14-08	8	13.0	15.0	41.0	35.0	38.0	21.5	40.0	203.0	244.0	90.0	26.0	2.5	12	1.21
10-H14-10	10	15.5	17.5	48.0	45.0	48.0	25.5	51.0	244.0	289.0	108.0	27.0	4.0	7	2.20
10-H14-13	13	17.0	19.0	55.0	53.6	63.0	32.0	59.0	295.0	354.0	138.0	40.0	6.7	4	4.40
10-H14-16	16	21.5	26.0	62.0	62.0	75.0	38.0	66.0	348.0	424.0	170.0	50.0	10.0	3	7.48
10-H14-20	20	26.5	28.5	76.0	76.0	85.0	50.0	76.0	399.0	489.0	191.0	62.0	16.0	2	13.75
10-H14-22	22	33.0	33.0	97.0	79.0	100.0	52.0	100.0	469.0	566.0	205.0	65.0	19.0	1	18.81
10-H14-26	26	42.0	42.0	123.0	100.0	107.0	60.0	119.0	565.0	688.0	251.0	81.0	26.5	1	31.40
10-H14-32	32	52.0	52.0	152.0	135.0	152.0	75.0	153.0	680.0	830.0	329.0	101.0	40.0	1	65.0

Imperial Specifications

Part Code	Chain Size inch	A inch	B inch	C inch	D inch	E inch	F inch	G inch	H inch	I inch	J inch	K inch	WLL lbs	Box Qty.	Mass lbs
10-H14-08	5/16	0.51	0.59	1.61	1.38	1.49	0.85	1.57	7.99	9.60	3.54	1.02	5700	12	2.66
10-H14-10	3/8	0.61	0.69	1.89	1.77	1.89	1.00	2.00	9.60	11.38	4.25	1.06	8800	7	4.85
10-H14-13	1/2	0.67	0.75	2.16	2.11	2.48	1.26	2.32	11.61	13.94	5.43	1.57	15000	4	9.70
10-H14-16	5/8	0.85	1.02	2.44	2.44	2.95	1.49	2.60	13.70	16.99	6.69	1.97	22600	3	16.49
10-H14-20	3/4	1.04	1.12	2.99	2.99	3.35	1.97	2.99	15.71	19.25	7.52	2.44	35300	2	30.31
10-H14-22	7/8	1.30	1.30	3.82	3.11	3.94	2.05	3.94	18.46	22.28	8.07	2.56	42700	1	41.47
10-H14-26	1	1.65	1.65	4.84	3.94	4.21	2.36	4.69	22.24	27.08	9.88	3.18	59800	1	69.23
10-H14-32	1-1/4	2.05	2.05	5.98	5.31	5.98	2.95	6.02	26.77	32.68	12.95	3.97	90400	1	143.30

Reevable Link

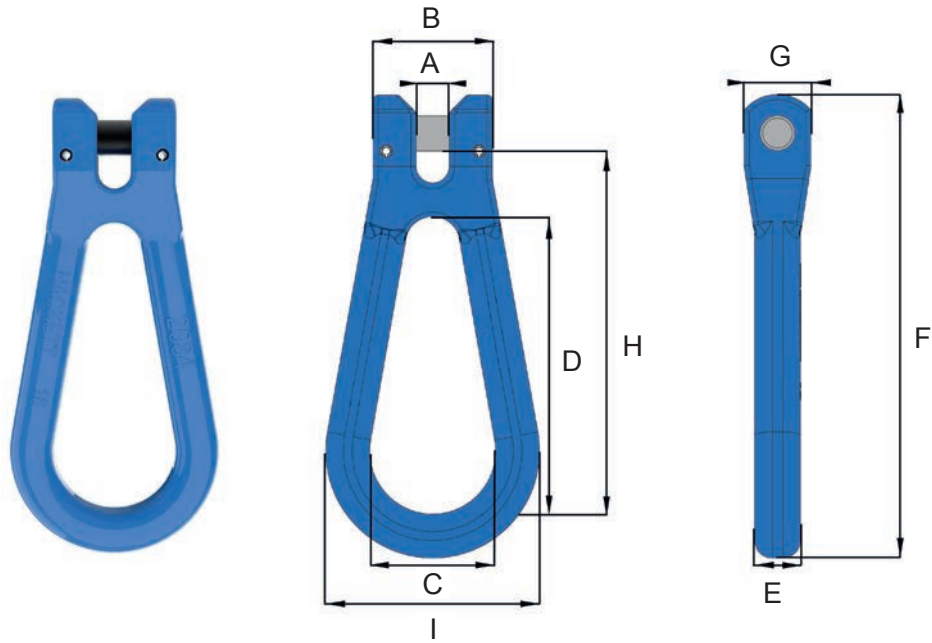

Metric Specifications

Part Code	Chain Size mm	A mm	B mm	C mm	D mm	E mm	F mm	G mm	H mm	WLL tonnes	Box Qty.	Mass Kg
10-H07-08	8	10.0	35.5	45.0	87.0	15.0	139.0	23.0	111.0	2.5	40	0.53
10-H07-10	10	12.0	42.0	60.0	108.0	19.0	174.0	27.0	128.0	4.0	20	0.74
10-H07-13	13	16.5	58.0	66.5	137.5	22.0	228.0	33.0	177.0	6.7	10	1.76
10-H07-16	16	19.0	68.0	72.0	165.0	26.0	264.0	39.0	207.0	10.0	8	2.80

Imperial Specifications

Part Code	Chain Size inch	A inch	B inch	C inch	D inch	E inch	F inch	G inch	H inch	WLL lbs	Box Qty.	Mass lbs
10-H07-08	5/16	0.39	1.40	1.77	3.42	0.59	5.47	0.91	4.37	5700	40	1.16
10-H07-10	3/8	0.47	1.65	2.36	4.25	0.75	6.85	1.06	5.04	8800	20	1.63
10-H07-13	1/2	0.65	2.28	2.62	5.41	0.87	8.98	1.30	6.97	15000	10	3.88
10-H07-16	5/8	0.75	2.68	2.83	6.49	1.02	10.39	1.54	8.15	22600	8	6.17

Clevis Shackle

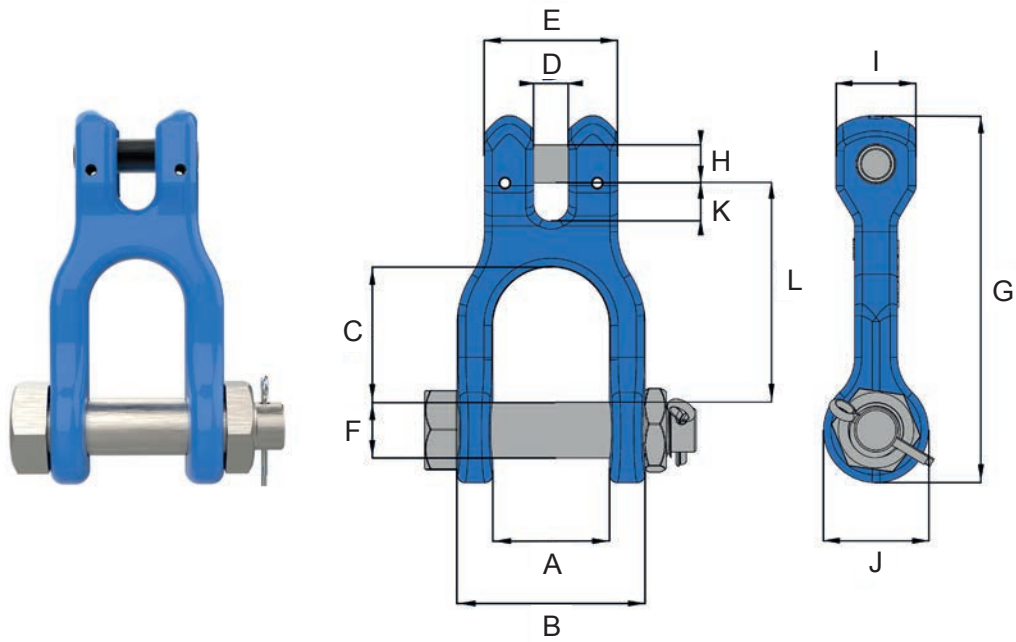

Metric Specifications

Part Code	Chain Size mm	A mm	B mm	C mm	D mm	E mm	F mm	G mm	H mm	I mm	J mm	K mm	L mm	WLL tonnes	Box Qty.	Mass Kg
10-H12-08	8	31.0	51.0	36.3	9.0	36.0	16.0	103.5	10.0	20.0	34.0	10.3	61.0	2.5	35	0.40
10-H12-10	10	34.0	62.0	48.0	12.5	46.5	20.0	130.7	13.2	25.0	40.0	13.0	78.5	4.0	20	0.89
10-H12-13	13	49.0	83.0	64.0	15.0	59.0	22.0	160.0	16.0	31.0	44.0	17.0	98.5	6.7	18	1.51
10-H12-16	16	58.0	95.0	69.5	19.0	70.0	28.5	190.5	19.7	40.0	55.0	20.5	114.0	10.0	10	2.62

Imperial Specifications

Part Code	Chain Size inch	A inch	B inch	C inch	D inch	E inch	F inch	G inch	H inch	I inch	J inch	K inch	L inch	WLL lbs	Box Qty.	Mass lbs
10-H12-08	5/16	1.22	2.01	1.43	0.35	1.42	0.63	4.07	0.39	0.79	1.34	0.41	2.40	5700	35	0.88
10-H12-10	3/8	1.34	2.44	1.89	0.49	1.83	0.79	5.15	0.52	0.98	1.57	0.51	3.09	8800	20	1.96
10-H12-13	1/2	1.93	3.27	2.52	0.59	2.32	0.87	6.30	0.63	1.22	1.73	0.67	3.88	15000	18	3.32
10-H12-16	5/8	2.28	3.74	2.74	0.75	2.75	1.12	7.50	0.78	1.57	2.17	0.39	4.49	22600	10	5.77

Please consider the environment when it comes to disposing of this brochure. Please recycle when you are finished with this item.
For more information please visit: www.recycle-more.co.uk

© William Hackett 2021-2023



e: liftingsales@williamhackett.co.uk
www.williamhackett.co.uk
t: 01665 604200 f: 01665 604204

William Hackett Lifting Products Limited
Oak Drive, Lionheart Enterprise Park
Alnwick, Northumberland
United Kingdom
NE66 2EU